

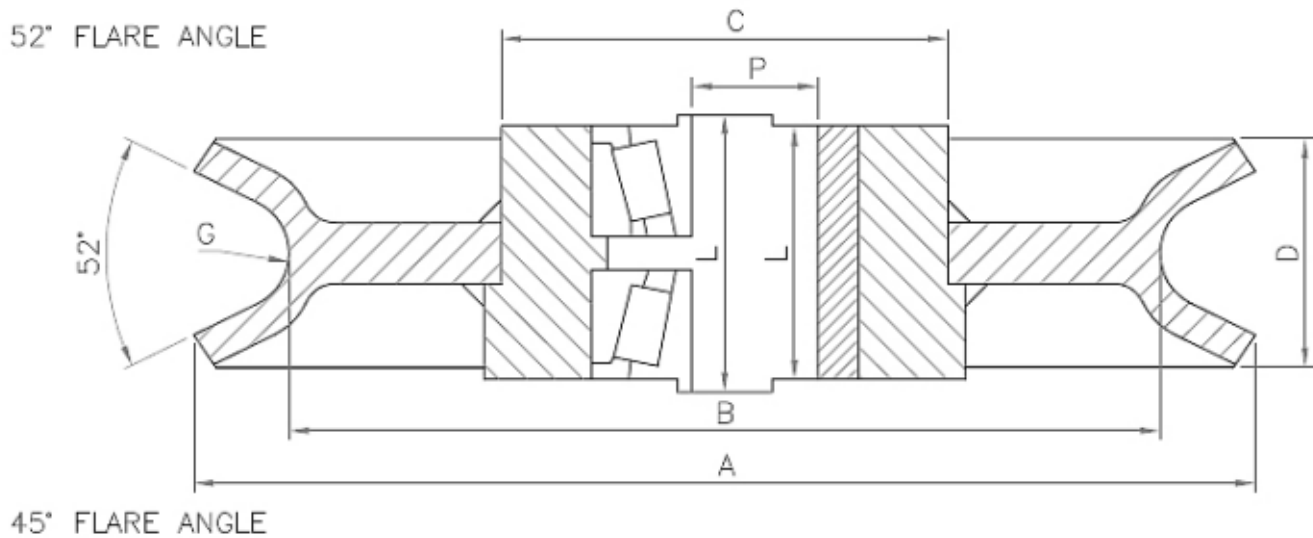

Industrial Sheaves



Technical Schematics :

Sheave O/D Ins	Rope Dia mm	A	B	Nominal D	G	C	Bush L	P	Taper Roller Bearings			Nominal Wt (Kg)
									C	L	P	
6	5 - 6	155	125	26	3.2	30	30	15	53	30	15	1.00
7 1/2	7 - 8	190	160	28	4.3	38	40	20	68	40	20	2.00
9 1/4	8 - 10	235	200	30	5.3	53	45	30	97	45	30	4.00
11 1/2	10 - 12	290	250	34	6.4	60	50	35	103	50	35	5.50
12 3/4	12 - 14	325	280	37	7.5	82	6	45	130	60	45	9.00
14 3/8	15 - 17	365	315	40	8.6	87	70	50	145	70	50	10.50
16 3/8	17 - 19	415	355	4	9.7	96	75	60	165	75	60	19.00
18 3/4	19 - 21	465	400	56	10.8	108	90	65	176	90	65	25.00

The above information demonstrates a range of sheaves we manufacture but are not in general kept on an ex-stock basis.

With our system of manufacture any size of sheave up to 710mm can be produced providing that the quantity warrants a machine batch rather than a one off process where we would supply a machined steel sheave.



Industrial Sheaves



Technical Schematics :

Sheave O/D Ins	Rope Dia mm	A	B	Nominal D	G	C	Bush L	P	Taper Roller Bearings			Nominal Wt (Kg)
									C	L	P	
7	7 - 8	177	152	23	4.5	100			100	60.32	38.1	2.50
7 5/8	10 - 12	194	164	30	6.5	70	41	34.92	90	44.45	34.92	2.50
7 3/4	7 - 8	196	172	24	4.2	90			90	44.45	34.92	2.50
9 1/2	9 - 11	242	209	30	5.8	115			115			4.00
9 1/2	9 - 12	240	204	35	6.5	140			140			
10	12 - 14	254	218	34	7.5	70	44	34.92	90	47.62	34.92	4.00
10 3/4	14 - 16	273	229	39	8.5	133			133			5.00
12	14 - 16	305	263	38	8.5	100	51	50.8	145	53.97	57.15	8.00
12 1/2	16 - 18	318	274	41	9.5	112	51	63.5	145	53.97	57.15	8.00
13 7/8	14 - 16	352	304	41	8.5	150			150			9.00
14	13 - 14	357	305	42	7.5	112	51	63.5	145	53.97	57.15	9.50
14	17 - 19	357	307	44	10	112	51	63.5	145	53.97	57.15	9.50
14 3/8	16 - 18	364	310	50	9.5	106			106			
16	20 - 22	406	346	51	11.5	135	64	76.2	155	69.85	63.5	18.00
18	15 - 18	457	393	54	9.5	100			100			23.00
18	22 - 24	457	393	56	12.5	155	64	88.9	155	69.85	63.5	23.00
20	25 - 27	508	434	65	14	155	87	88.9	200	92.07	82.55	30.00
22	26 - 28	559	481	67	14.5	155	96	88.9	200	101.6	82.55	33.00
24	30 - 32	610	518	76	16.5	175	96	114.3	218	101.6	101.6	39.00
24	21 - 24	610	544	60	12.5	155	96	88.9	155	75	70	39.00
26	32 - 35	660	564	83	18.5	185	96	127	218	101.6	101.6	47.00
27	34 - 37	686	582	87	19.5	200	96	139.7	249	107.95	107.95	52.00
28	35-38	711	605	90	20	220	96	152.4	249	107.95	107.95	59.00

The above information demonstrates a range of sheaves we manufacture but are not in general kept on an ex-stock basis.

With our system of manufacture any size of sheave up to 710mm can be produced providing that the quantity warrants a machine batch rather than a one off process where we would supply a machined steel sheave.